

ACE

Order Picker



**INDIA'S NO. 1
CRANE BRAND**



Distinguishing mark				
1.1	Manufacturer			EP
1.2	Model designation			JX0
1.3	Drive unit			E
1.4	Operator type			Task support vehicle
1.5	rated capacity	Q 1	kg	90
		Q 2	kg	110
		Q 3	kg	136
1.6	Load center distance	c	mm	—
1.8	Load distance , centre of drive axle to fork	x	mm	—
1.9	Wheelbase	y	mm	1095
Weight				
2.1	Service weight (include battery)		kg	800
2.2	Axle loading, laden driving side/loading side		kg	—
2.3	Axle loading, unladen driving side/loading side		kg	370/430
Types,Chassis				
3.1	Tyre type, Driving wheels/Loading wheels			PURubber
3.2	Tyre size, driving wheels (Diameter×Width)		mm	210×70
3.3	Tyre size, loading wheels (Diameter×Width)		mm	250×100
3.4	Tyre size, caster wheels (Diameter×Width)		mm	—
3.5	Wheels, number driving , caster/loading (x=drive wheels)		mm	1x , 2/2
3.6	Track width, front,driving side	b10	mm	545
3.7	Track width,rear,loading side	b11	mm	640
Dimensions				
4.2	Height, mast lowered	h1	mm	—
4.4	Lift height)	h3	mm	3620
4.5	Height, mast extended)	h4	mm	—
4.7	Height of overhead guard (cabin)	h6	mm	—
4.8	Seat height/standing height)	h7	mm	275
4.14	Stand height, elevated	h12	mm	3000
4.15	Lowered height	h13	mm	—
4.19	Overall length	l1	mm	1440
4.20	Length to face of forks	l2	mm	—
4.21	Overall width	b1/ b2	mm	750
4.22	Fork dimensions	s/ e/ l	mm	—
4.25	Outside width of the forks	b5	mm	—
4.32	Ground clearance, center of wheelbase	m2	mm	35
4.34.1	Aisle width for pallets 1000 × 1200 crossways	Ast	mm	—
4.34.2	Aisle width for pallets 800 × 1200 lengthways	Ast	mm	—
4.35	Turning radius	Wa	mm	1260
Performance data				
5.1	Travel speed, laden/ unladen (H:0-500mm)		km/ h	6/6.5
	Travel speed, laden/ unladen (H:500-1000mm)		km/ h	3
	Travel speed, laden/ unladen (H:1000-2000mm)		km/ h	2
	Travel speed, laden/ unladen (H:2000-3000mm)		km/ h	1
5.2	Lifting speed, laden/ unladen (Q3)		m/ s	0.213/0.225
	Lifting speed, laden/ unladen (Q1)		m/s	0.023/0.028
5.3	Lowering speed, laden/ unladen) (Q3)		m/ s	0.230/0.233
	Lowering speed, laden/ unladen) (Q1)		m/ s	0.030/0.029
5.8	Max. gradeability, laden/unladen		%	5/8
5.10	Service brake type			Electromagnetic
Electric-engine				
6.1	Drive motor rating S2 60 min		kW	0.65
6.2	Lift motor rating at S3 15%		kW	2.2
6.3	The maximum allowed size battery		mm	
6.4	Battery voltage/nominal capacity K5		Wh	24V/120Ah
6.5	Battery weight		kg	30x2
Addition data				
8.1	Type of drive unit			DC
10.5	Steering type			Electronic steering
10.7	Sound pressure level at the driver's ear		dB (A)	74

If there are improvements of technical parameters or configurations, no further notice will be given.
The diagram shown may contain non-standard configurations.

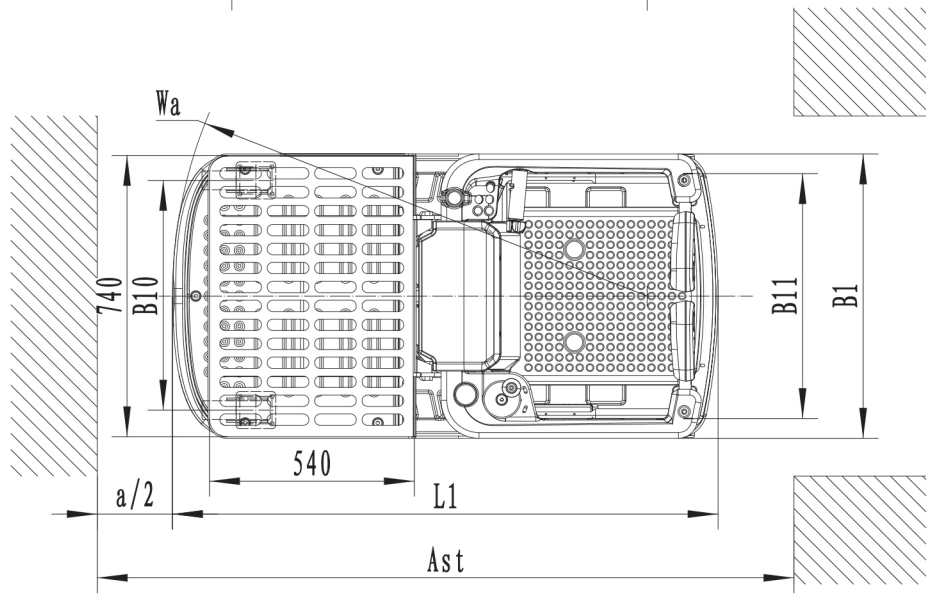
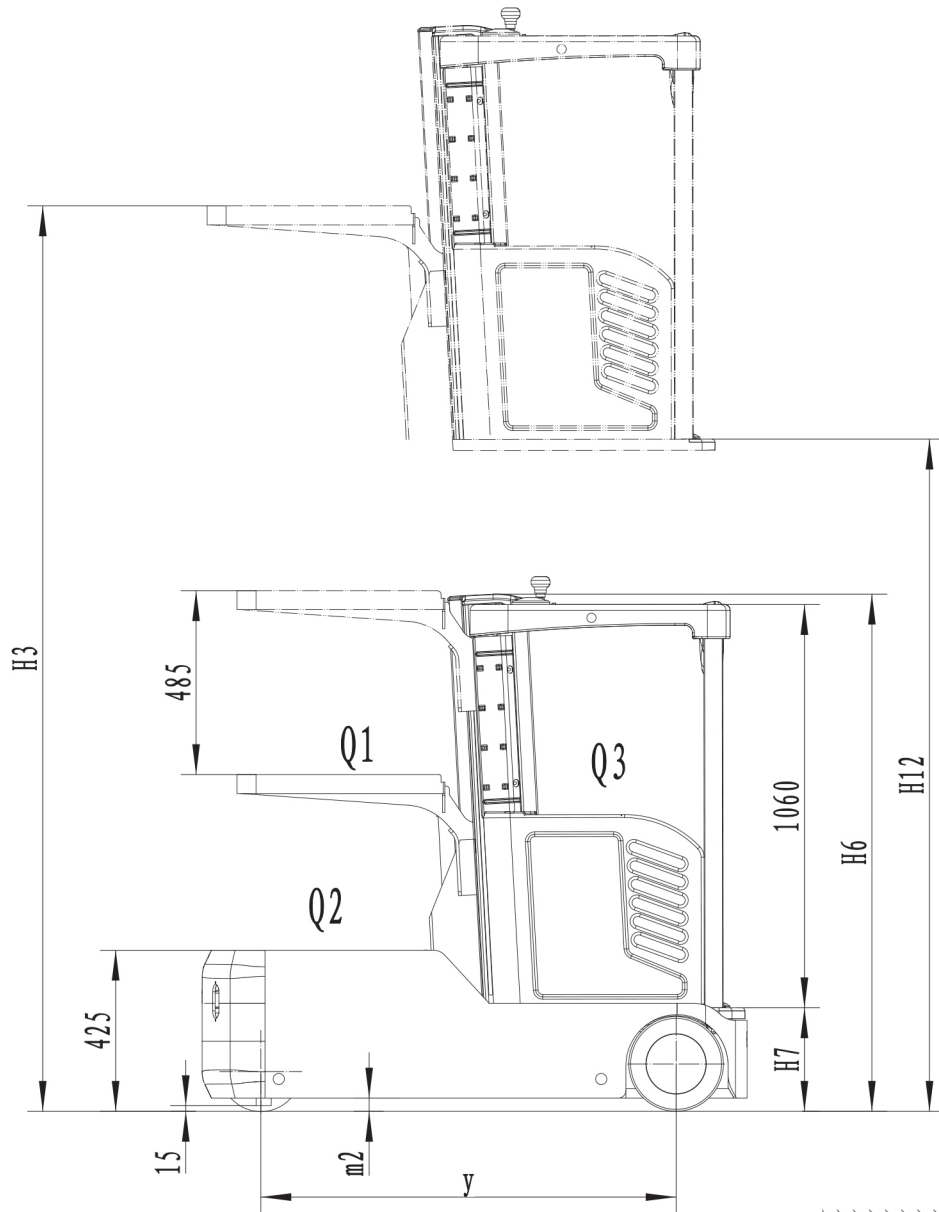

BUILT TO PERFORM



**RELIABLE AND
DEPENDABLE
EFFICIENCY**

NETWORK

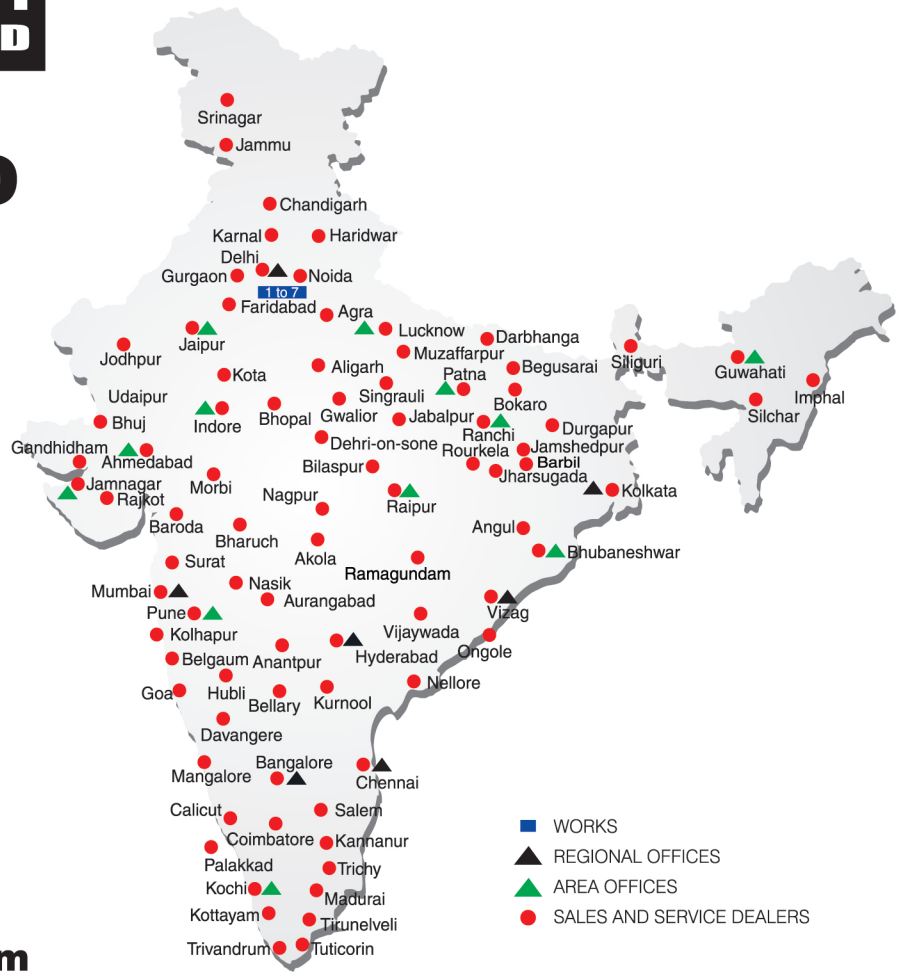

**Toll Free Help Line
1800 1800 004**

www.ace-cranes.com

MARKETING H.Q.

4th Floor, Pinnacle
Surajkund, NCR-121009
Ph. : +91-129-4550000
Fax : +91-129-4550022
E-mail: marketing@ace-cranes.com

REGISTERED OFFICE

Dudhola Link Road, Dudhola
Palwal-121102, Haryana
Ph.: +91-1275-280111
Fax: +91-1275-280133
CIN : L74899HR1995PLC053860

MUMBAI OFFICE

31, "Kalpataru Court"
Chembur, Mumbai - 400074
Ph.: +91-22-25206846, 25207070
Fax: +91-22-25207071
E-mail: acemumbai@ace-cranes.com

KOLKATA OFFICE

"Forma Towers" 84-A, Second Floor
AJC Bose Road, Kolkata - 700014
Ph.: +91-9038070630
E-mail: acekolkata@ace-cranes.com

CHENNAI OFFICE

1st Floor, "Alsa Regency", 165
Eldams Road, Alwar Pet
Chennai - 600018
Ph.: +91-44-24314253
Fax: +91-44-24314252
E-mail: acechennai@ace-cranes.com

HERE TO SERVE YOU.

SPARE PARTS & SERVICE

ACE has all India Sales and Service network operating out of all the major cities. These outlets are fully equipped to provide genuine spare parts and services by company trained engineers. These outlets are further supported by company officials based at Delhi, Mumbai, Chennai, Kolkatta, Ahmedabad, Surat, Pune, Jaipur, Chandigarh, Ranchi, Raipur, Indore, Bhubneshwar, Lucknow, Jamnagar, Hyderabad, Bangalore, Guwahati, Patna, Vizag & Kochi.



Action Construction Equipment Ltd.

Contact:



ACE reserves the right to alter any specifications without prior notice. Dimensions, weights & capacities mentioned herein are variable by ± 5%. Accessories if shown are not part of the Standard Equipment.